

## Technical sheet WINE **Vinolok 17.5 Low Top**



The glass closure VINOLOK is a part of a system consisting of a glass closure, a bottle and a fixation capsule.

### Closure

Closure: Glass without added lead  
 Sealing ring: 17.5 Elvax 550A  
 Available colours: Clear  
 of closure: Clear

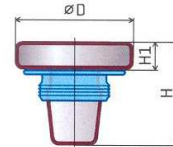

$\varnothing D = 29.3 \pm 0.30$  mm  
 $H = 27.0 \pm 0.20$  mm  
 $H1 = 7.0 \pm 0.15$  mm  
 $m = 19.0 \pm 0.2$  g

### Bottle

Inner diameter:  $17.5 \pm 0.5$  mm Upper band finish

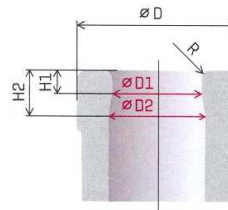

$\varnothing D = 29.3 \pm 1.0$  mm  
 $H1 = 3.0$  mm  
 $H2 = 6.0$  mm  
 $R = 1.5$  mm

$\varnothing D1 \leq \varnothing D2$   
 $\varnothing D1; \varnothing D2 = 17.5 \pm 0.5$  mm

Please contact your Vinolok supplier for the suitable bottle selection.

Inner shape: The bottle neck mustn't narrow down in the downward direction.

### Capsule

Type: aluminium, tin, poly-laminate  
 Thickness: 0.075 - 0.12 mm

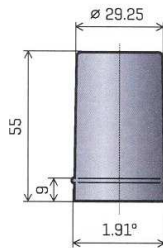

shrink  
 0.08 mm

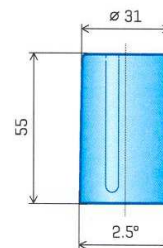

### Application

Closure temperature for application: 10 - 30°C  
 Closure insert force: 50 - 300 N [5 - 30 kg]  
 Capsule shrinking temperature:

10 - 30°C  
 50 - 300 N [5 - 30 kg]  
 max 280°C

### Maximum permitted ambient temperature

Headspace: 40 mm 60 mm  
 Max. ambient temperature: 35°C 45°C

40 mm 60 mm  
 35°C 45°C

(for wines with alcohol content up to 15%, bottling temperature 15°C)

### Printing

Art specified by costumer max. 4 colours, up to diameter of 17,5 mm

### Package

1 blister (60 pieces) 40x26x3,5 cm / 1,3 kg  
 Pieces in carton (480) 40x26x24 cm / 10,4 kg  
 Number of cartons / closures on palette: 54 / 25 920 120x80x160 cm / 579 kg

### Declaration of conformity

EC No. 1935/2004 a EC No. 10/2011

### Recommended closure storage

dry environment  
 10-30°C, out of direct sunlight



## Technical sheet WINE

### Vinolok 17.5 High Top 3



The glass closure VINOLOK is a part of a system consisting of a glass closure, a bottle and a fixation capsule.

#### Closure

Closure: Glass without added lead  
 Sealing ring: 17.5 Elvax 550A  
 Available colours: Clear  
 of closure:

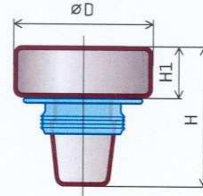

$\varnothing D = 27.5 \pm 0.30 \text{ mm}$   
 $H = 32.0 \pm 0.20 \text{ mm}$   
 $H1 = 12.0 \pm 0.15 \text{ mm}$   
 $m = 25.0 \pm 0.2 \text{ g}$

#### Bottle

Inner diameter:  $17.5 \pm 0.5 \text{ mm}$  Upper band finish

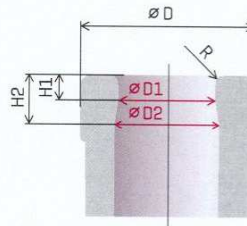

$\varnothing D = 27.5 \pm 1.0 \text{ mm}$   
 $H1 = 3.0 \text{ mm}$   
 $H2 = 6.0 \text{ mm}$   
 $R = 1.5 \text{ mm}$

$\varnothing D1 \leq \varnothing D2$   
 $\varnothing D1; \varnothing D2 = 17.5 \pm 0.5 \text{ mm}$

Please contact your Vinolok supplier for the suitable bottle selection.

Inner shape: The bottle neck mustn't narrow down in the downward direction.

#### Capsule

Type: aluminium, tin, poly-laminate  
 Thickness: 0.075 - 0.12 mm

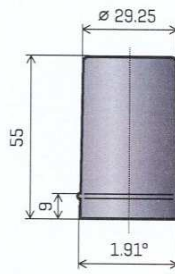

shrink  
 0.08 mm

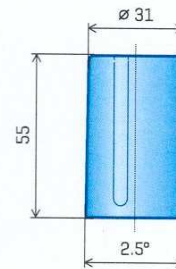

#### Application

Closure temperature for application: 10 - 30°C  
 Closure insert force: 50 - 300 N [5 - 30 kg]  
 Capsule shrinking temperature:

10 - 30°C  
 50 - 300 N [5 - 30 kg]  
 max 280°C

#### Maximum permitted ambient temperature

Headspace: 40 mm    60 mm  
 Max. ambient temperature: 35°C    45°C

40 mm    60 mm  
 35°C    45°C

(for wines with alcohol content up to 15%, bottling temperature 15°C)

#### Printing

Art specified by customer max. 4 colours, up to diameter of 17,5 mm

#### Package

1 blister (60 pieces)    40x26x3,5 cm / 1,6 kg  
 Pieces in carton (480)    40x26x25 cm / 11,8 kg  
 Number of cartons / closures on palette: 54 / 25 920    120x80x165 cm / 654 kg

#### Declaration of conformity

EC No. 1935/2004 a EC No. 10/2011

#### Recommended closure storage

dry environment  
 10-30°C, out of direct sunlight